

Apt 4, 523 Ventry Court, Barlow Moor Road, Chorlton, Manchester, M21 8AQ



**JP&Brimelow**  
ESTATE AGENTS



# Offers In The Region Of £265,000

2 1 1 C

**\*\*VIDEO TOUR AVAILABLE\*\*** An immaculately presented & spacious, TWO DOUBLE BEDROOM, raised ground floor apartment, positioned at the front of this development. This attractive detached period conversion is located in the heart of Chorlton on Barlow Moor Road. Situated within walking distance to the centre of Chorlton and all its amenities. The Metrolink station on Wilbraham Road gives you direct access into the city centre, media city and Manchester International Airport and it is strolling distance from Beech Road, with all its independent bars, cafes, restaurants and Chorlton Park. The well-planned accommodation consists of a communal entrance hall, a private entrance hall, two double bedrooms, a modern fitted three-piece shower room, a fitted high gloss kitchen and a well portioned lounge/dining room with a bay window to the front aspect. The apartment benefits from an alarm, is warmed by gas fired central heating, has communal off-road parking to the rear and a communal lawned enclosed garden to the rear aspect. Ideally suit a couple or a professional individual due to the location. Early viewing is highly recommended.







## EPC Chart

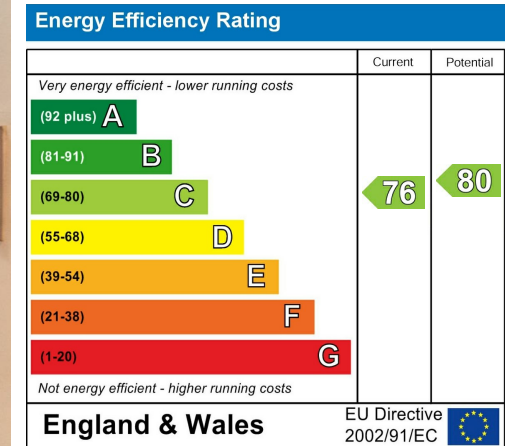

Tenure: **Leasehold** Council Tax Band: **B**

## Ground Floor

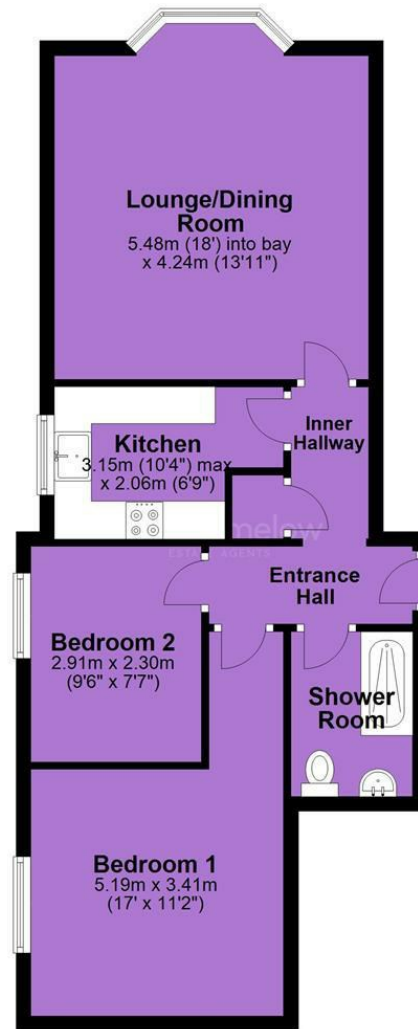

JP & Brimelow Estate Agents Ltd  
430 Barlow Moor Road, Manchester, M21 8AD  
Tel: 0161 8822233  
E: sales@jpbrimelow.co.uk www.jpandbrimelow.co.uk



**JP & Brimelow**  
ESTATE AGENTS

NOTICE: JP & Brimelow Estate Agents Ltd for themselves and for the vendors or lessors of this property whose agents they are give notice that:

- (i) the particulars are set out as a general outline only for the guidance of intending purchasers or lessees, and do not constitute, nor constitute part of, an offer or contract;
- (ii) all descriptions, dimensions, references to the condition and necessary permissions for use and occupation, and other details are given in good faith and are believed to be correct but any intending purchasers or tenants should not rely on them as statements or representations of fact but must satisfy themselves by inspection or otherwise as to the correctness of each of them;
- (iii) no person in the employment of JP & Brimelow Estate Agents Ltd has any authority to make or give any representation or warranty whatever in relation to this property.

jpandbrimelowestateagents

@jpandbrimelow